

4

3

2

1

D

D

C

C

B

B

A

A

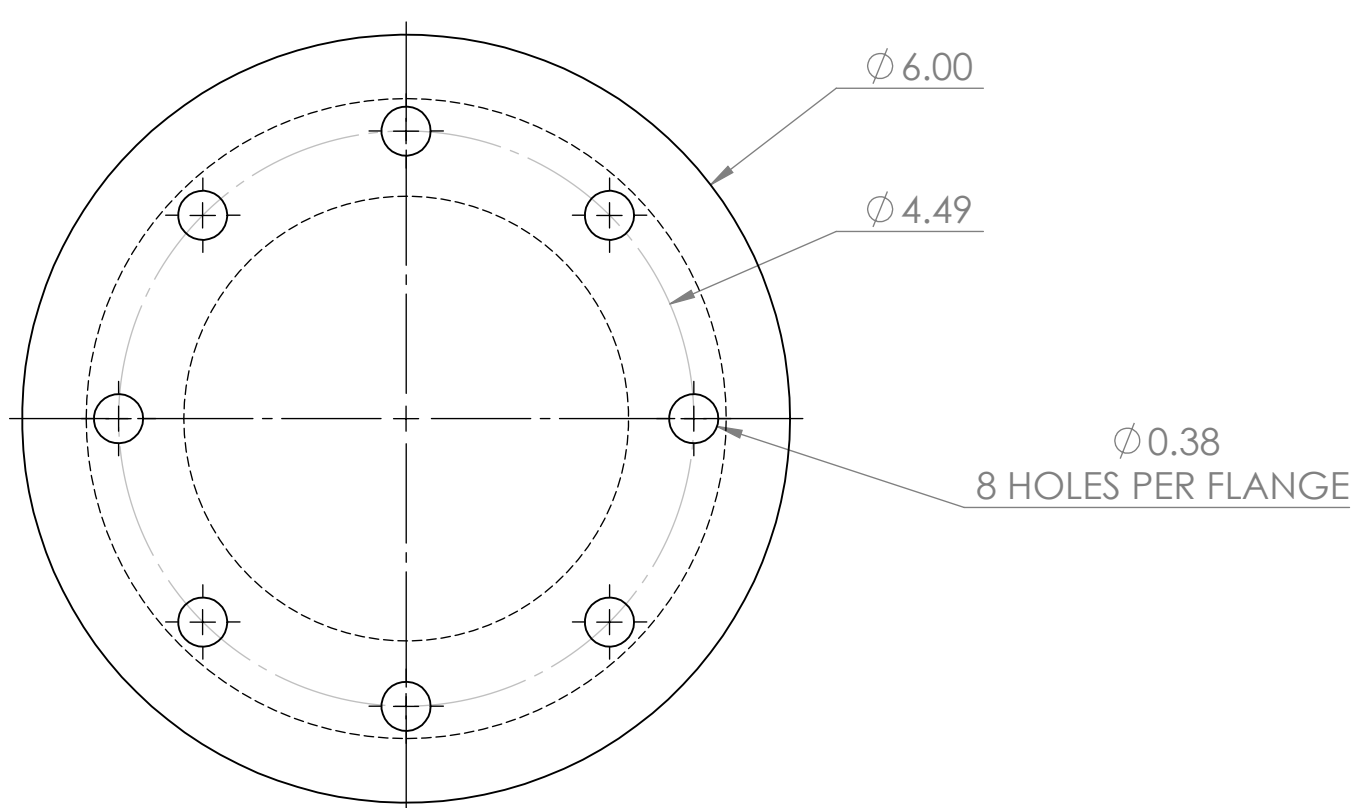
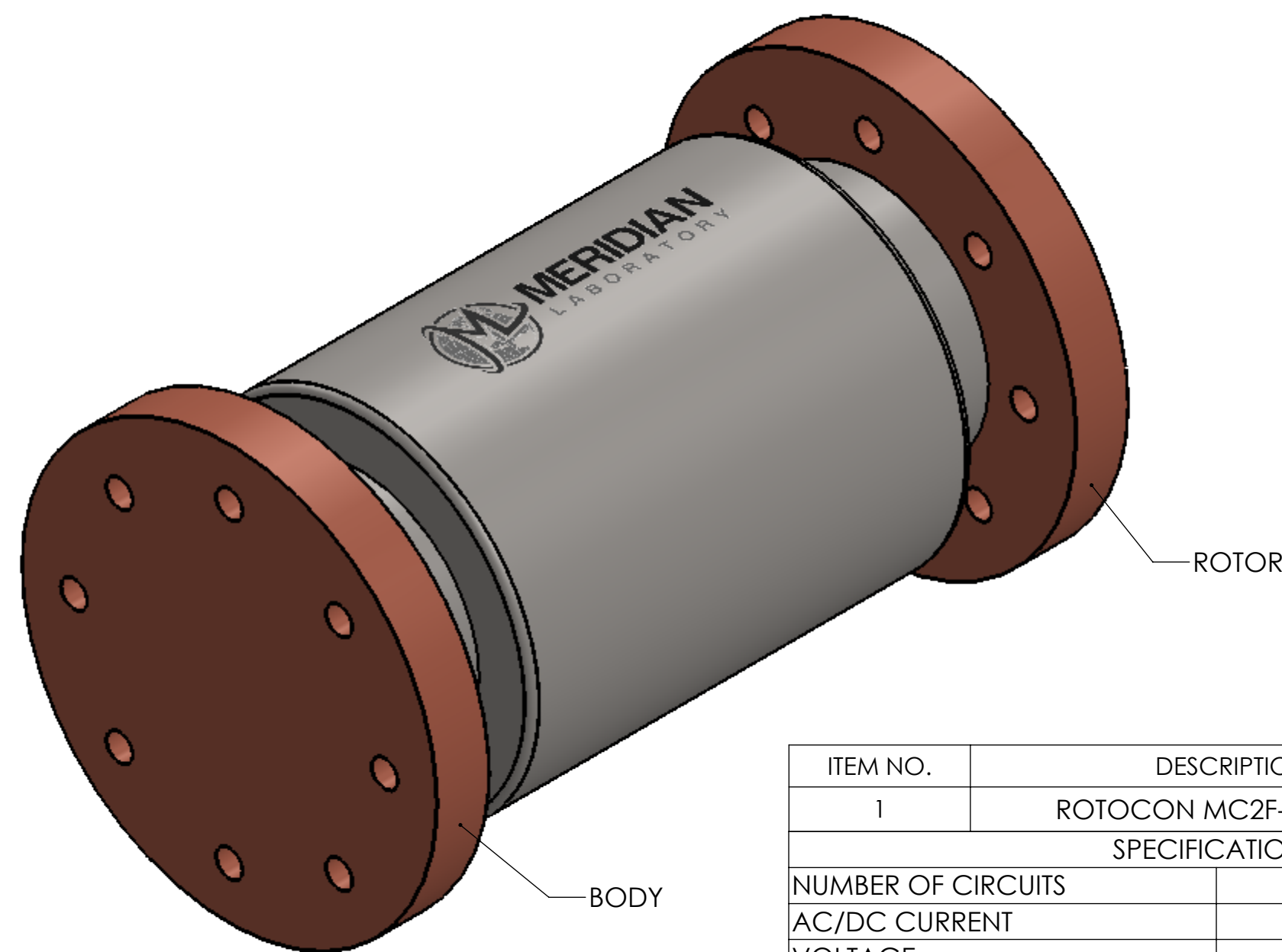
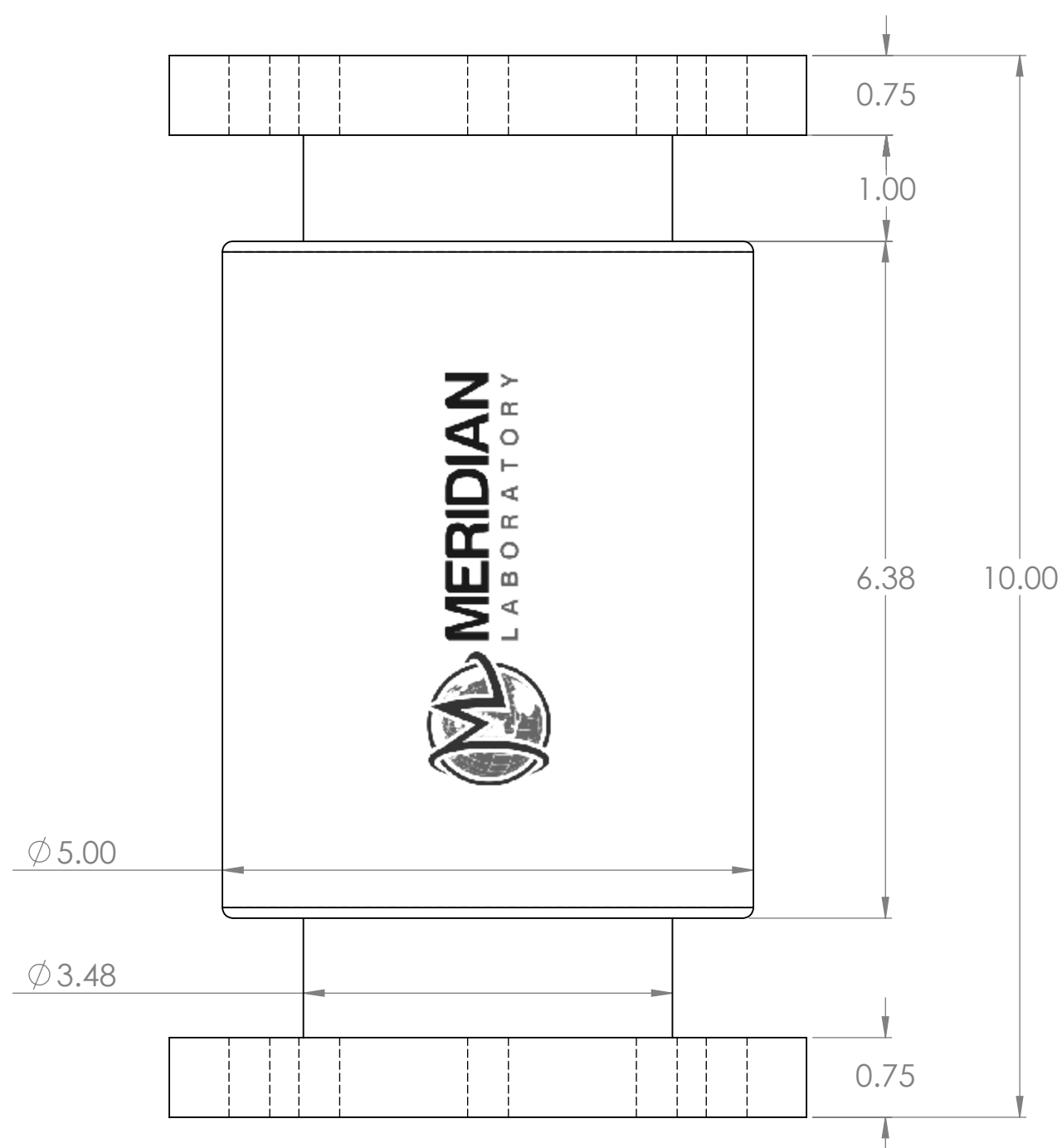

ITEM NO.	DESCRIPTION	QTY.
1	ROTOCON MC2F-3000 UNIT	1
SPECIFICATIONS		
NUMBER OF CIRCUITS	1	
AC/DC CURRENT	3,000A	
VOLTAGE	N/A	
FREQUENCY	0 TO 250 MHz <small>(OPTIONAL UP TO 1 GHz WITH CERTAIN MODELS AND APPLICATIONS)</small>	
NOMINAL RPM	0 TO 20	
TEMPERATURE	-20 TO 70°C	
HOUSING MATERIAL	304 STAINLESS STEEL	
CONTACT RESISTANCE	<1 mΩ	
DYNAMIC RESISTANCE	<1 mΩ (0 TO 250 RPM)	
WEIGHT (± 15%)	48 LBS	
ADDITIONAL OPTIONS	SEE <a href="#">PRODUCT PAGE</a>	
ABSOLUTE MAXIMUMS UNDER 60 SECONDS		
AC CURRENT	4,500A, f=60 Hz	
DC CURRENT	4,500A	
RPM	450	

- NOTES
1. THE ABSOLUTE MAXIMUMS SHALL NOT EXCEED A TIME DURATION OF 60 SECONDS.
  2. SPECIFICATIONS ARE NOT GUARANTEED WHILE IN AN ABSOLUTE MAXIMUM CONDITION.
  3. THE PRODUCT IS NOT GUARANTEED OUTSIDE OF ITS SPECIFICATIONS.
  4. WHILE NOT IN OPERATION, THE UNIT SHOULD BE STORED VERTICALLY, ROTOR END UP, AND ROTATED MONTHLY.
  5. BODY MAY BE MADE TO ROTATE WHILE ROTOR IS HELD STATIONARY IF DESIRED.
  6. ROTOR AND BODY ENDS MUST NOT BOTH BE HARD MOUNTED TO ALLOW FOR SLIGHT NON-CONCENTRIC ROTATION.
  7. ENSURE PROPER STRAIN RELIEF IS PROVIDED AND SIGNIFICANT SIDE LOADING IS AVOIDED.
  8. PRODUCT DIMENSIONS AND SPECIFICATIONS ARE PROVIDED FOR REFERENCE ONLY, ARE NOT GUARANTEED, AND ARE SUBJECT TO CHANGE WITHOUT NOTICE.

**PROPRIETARY AND CONFIDENTIAL**  
 THE INFORMATION CONTAINED IN THIS DRAWING IS THE SOLE PROPERTY OF MERIDIAN LABORATORY. ANY REPRODUCTION IN PART OR AS A WHOLE WITHOUT THE WRITTEN PERMISSION OF MERIDIAN LABORATORY IS PROHIBITED.

UNLESS OTHERWISE SPECIFIED:		NAME	DATE	MERIDIAN LABORATORY
DIMENSIONS ARE IN INCHES		DRAWN		
TOLERANCES:		CHECKED		TITLE:
FRACTIONAL ±		ENG APPR.		ROTOCON SINGLE-CONTACT HIGH CURRENT
ANGULAR: MACH ± BEND ±		MFG APPR.		SIZE DWG. NO.
TWO PLACE DECIMAL ±		Q.A.		C MC2F-3000
THREE PLACE DECIMAL ±		COMMENTS:		REV
INTERPRET GEOMETRIC TOLERANCING PER:				SCALE: 1:2 WEIGHT: 48 LBS SHEET 1 OF 1
MATERIAL MULTI-MATERIAL ASSEMBLY				
FINISH				
DO NOT SCALE DRAWING				

4

3

2

1